

NOTCHED PLATE

RA 130

NOTES

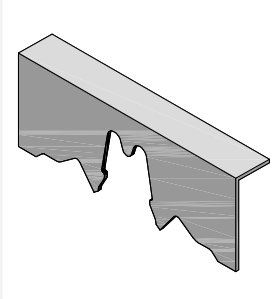

MATERIALS

mill finish aluminum
pre-painted aluminum
copper
stainless steel
galvanized steel
zinc

DIMENSIONS

20 x 50 x L.170 mm

SUITABLE FOR

Riverclack 500
Riverclack 550
Riverclack Grip 600

INCLUDED COMPONENTS

N°4 rivets Ø3.8x9 mm in the proper material

RELATED COMPONENTS

Silicone
(10 ml approx. for every item)

NOTES

Mandatory for low slope roofs (<6%)

INSTALLATION ADVISES

- Close the back end of the drainage channel with silicone
- Verify compatibility between fixing rivets and metal sheet

WWW.RIVERCLACK.COM

TECHNICAL SITUATION

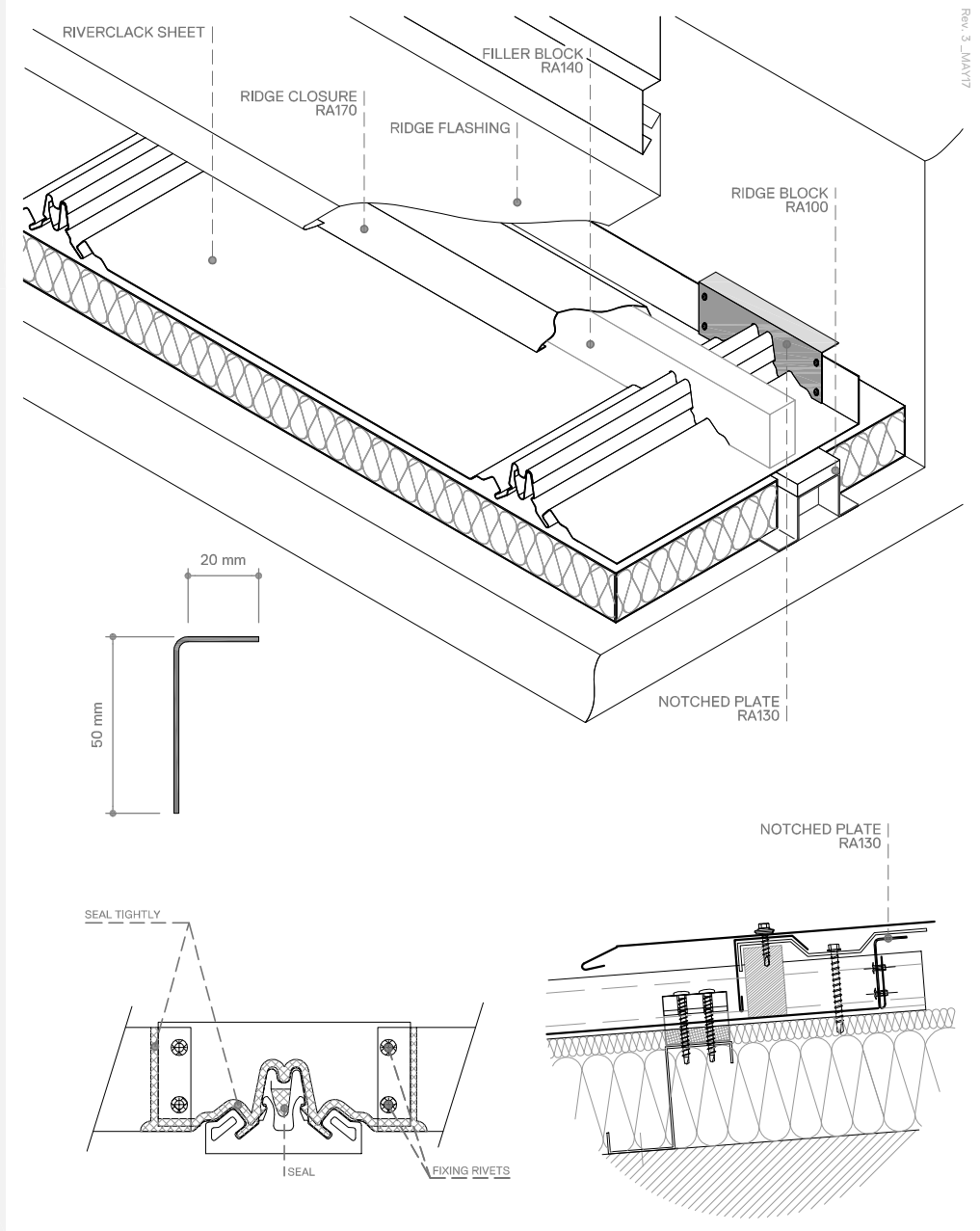

Rev. 3_1.MAY17

INSTALLATION SEQUENCE

